

- IN ORDER THAT YOUR PRODUCT IS NOT OUT OF THE WARRANTY, YOU MUST ASSEMBLE IN ACCORDANCE WITH THE INSTALLATION SCHEME.
- SPREAD ALL THE MATERIALS FROM THE PACKAGE ON A FLAT FLOOR IN ORDER THAT YOU HAVE NO DIFFICULTY IN ASSEMBLY.
- CHECK THE MATERIALS AND THEIR QUANTITIES STATED ON THE INSTALLATION DIAGRAM BEFORE STARTING THE INSTALLATION.
- MAKE THE INSTALLATION ON THE PRODUCT PACKAGING CARTON OR ON A FLAT FLOOR THAT WILL NOT SCRATCH THE PRODUCT.
- FOR INSTALLATION, 1 STAR WHEEL IS SUFFICIENT. USING ELECTRIC TOOLS IS IMPORTANT.
- FOR YOUR QUESTIONS AND OPINIONS REGARDING INSTALLATION, PLEASE CONTACT OUR AUTHORIZED DEALER.



ONE PERSON



SCREWDRIVER

## EXAMPLE OF INSTALLATION WITH MINIFIX

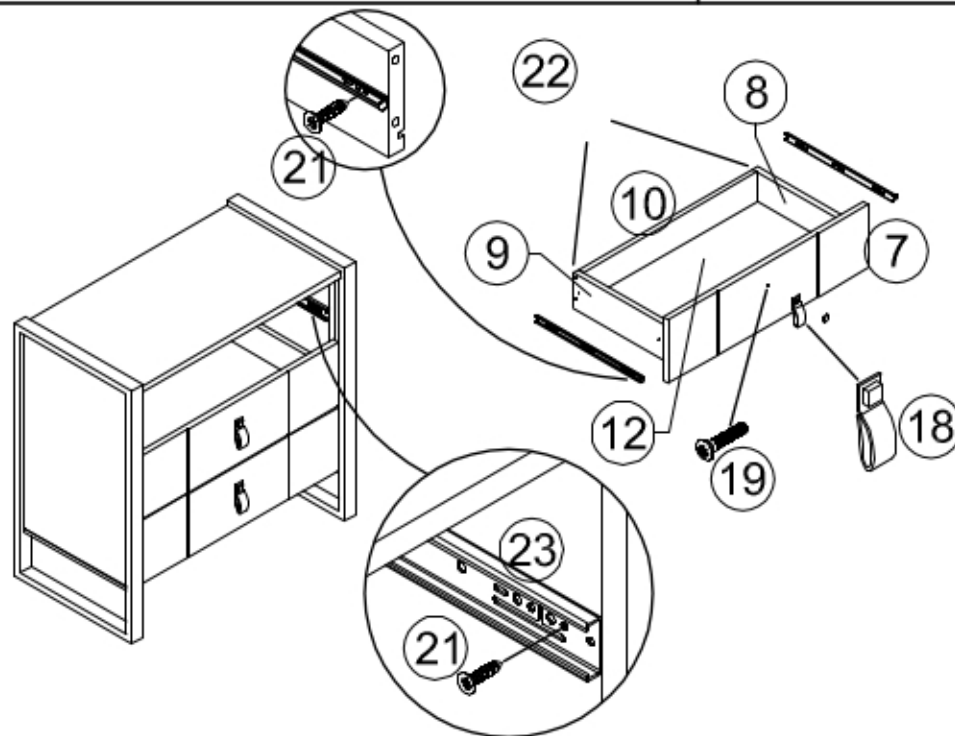
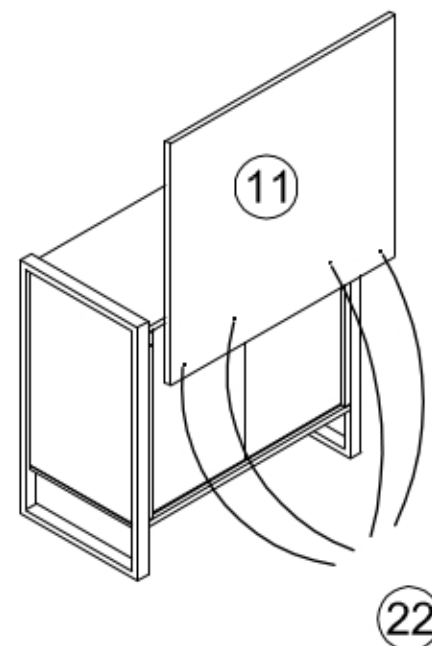
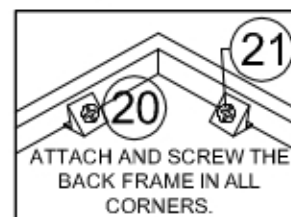
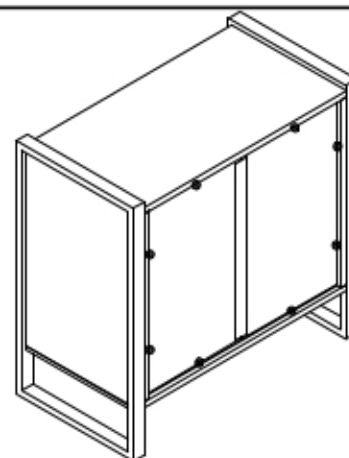
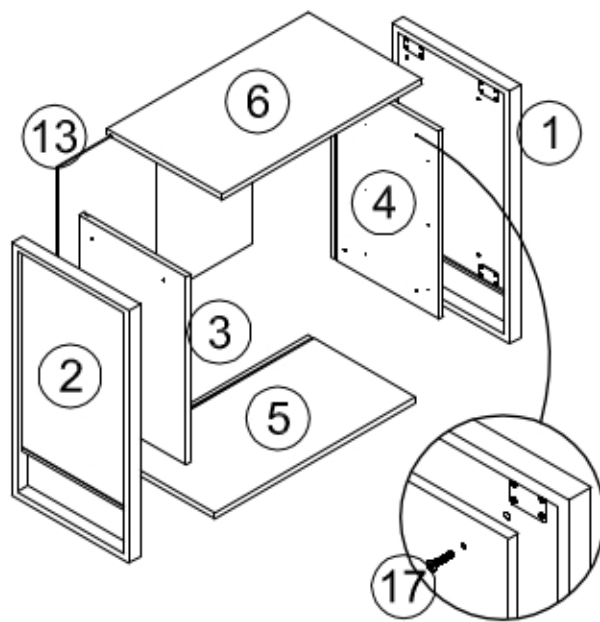
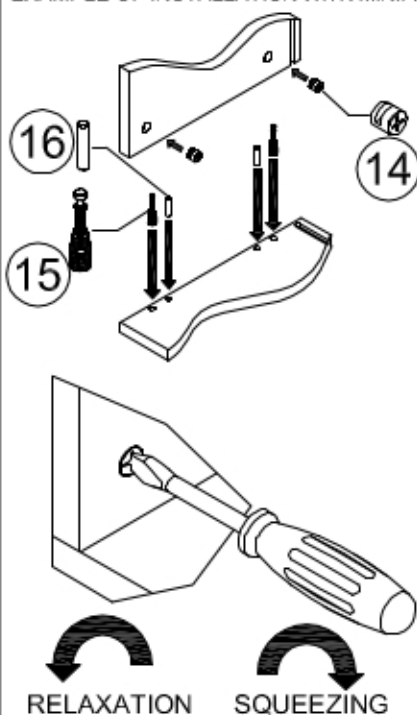

## ASSEMBLY MATERIAL BAG CONTENT

P.NO	MATERIALS	QTY	UNIT
13	MINIFIKS KAFA	20	PIECE
14	MINIFIKS GÖVDE	20	PIECE
15	KAVELA	14	PIECE
16	M6 X 30 YSB VIDA	8	PIECE
17	KULP	3	PIECE
18	M4*22 KULP VİDASI	3	PIECE
19	ARKALIK SIKIŞTIRICI	8	PIECE
20	3,5*18 VIDA	32	PIECE
21	KABİN VİDASI	16	PIECE
22	ÇEKMECE RAYI	3	SET

P.NO	TRACK NAME	COLOUR	COLOUR	THICKNESS	MEASUREMENT	
					X	Y
1	RIGHT METAL FOOT	A. PINE + METAL	1	40	784	420
2	LEFT METAL FOOT	A. PINE + METAL	1	40	784	420
3	INNER LEFT SIDE	ATLANTIC PINE	1	18	582	384
4	INNER RIGHT SIDE	ATLANTIC PINE	1	18	582	384
5	LOWER TABLE	ATLANTIC PINE	1	18	720	384
6	TOP TABLE	ATLANTIC PINE	1	18	720	409
7	DRAWER FRONT	ATLANTIC PINE	3	18	714	197
8	DRAWER RIGHT SIDE	ATLANTIC PINE	3	18	350	110
9	DRAWER LEFT SIDE	ATLANTIC PINE	3	18	350	110
10	BACK OF DRAWER	ATLANTIC PINE	3	18	622	110
11	MIRROR BOARD	ATLANTIC PINE	1	18	800	750
12	DRAWER BOTTOM	ONE FACE WHITE	3	5	632	342
13	BACKREST	ONE FACE WHITE	2	5	584	347
ASSEMBLY MATERIAL BAG			1			