

- IN ORDER THAT YOUR PRODUCT IS NOT OUT OF THE WARRANTY, YOU MUST ASSEMBLE IN ACCORDANCE WITH THE INSTALLATION SCHEME.
- SPREAD ALL THE MATERIALS FROM THE PACKAGE ON A FLAT FLOOR IN ORDER THAT YOU HAVE NO DIFFICULTY IN ASSEMBLY.
- CHECK THE MATERIALS AND THEIR QUANTITIES STATED ON THE INSTALLATION DIAGRAM BEFORE STARTING THE INSTALLATION.
- MAKE THE INSTALLATION ON THE PRODUCT PACKAGING CARTON OR ON A FLAT FLOOR THAT WILL NOT SCRATCH THE PRODUCT.
- FOR INSTALLATION, 1 STAR WHEEL IS SUFFICIENT. USING ELECTRIC TOOLS IS IMPORTANT.
- FOR YOUR QUESTIONS AND OPINIONS REGARDING INSTALLATION, PLEASE CONTACT OUR AUTHORIZED DEALER.



ONE PERSON



SCREWDRIVER

EXAMPLE OF INSTALLATION WITH MINIFIX

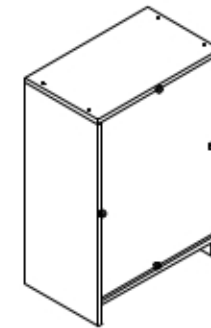
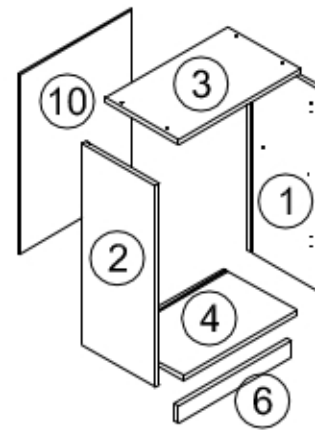
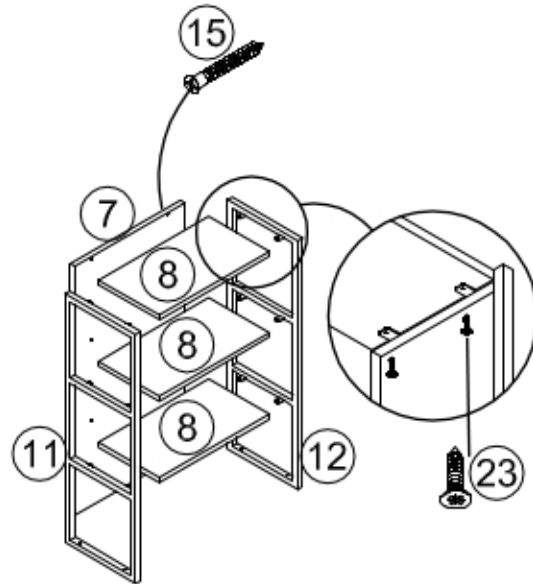
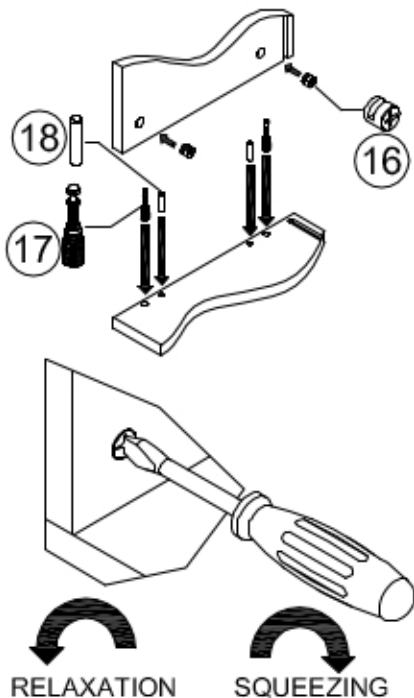

ARKALIK SIKIŞTIRICIYI
BÜTÜN KÖŞELERE ÇAKIN
VE VİDALAYIN.

CONTENTS OF ASSEMBLY MATERIAL BAG

P.NO	PRODUCT NAME	QTY	UNIT
13	FLAT HINGE	2	PIECE
14	HANDLE	1	PIECE
15	CABIN SCREW	6	PIECE
16	MINIFIX HEAD	8	PIECE
17	MINIFIX BODY	8	PIECE
18	DOWEL	10	PIECE
19	SHELF PIN	4	PIECE
20	BACKPACK PLASTIC	4	PIECE
21	M6*30 YSB	4	PIECE
22	M4*22 HANDLE SCREW	1	PIECE
23	3,5*18 SCREW	24	PIECE

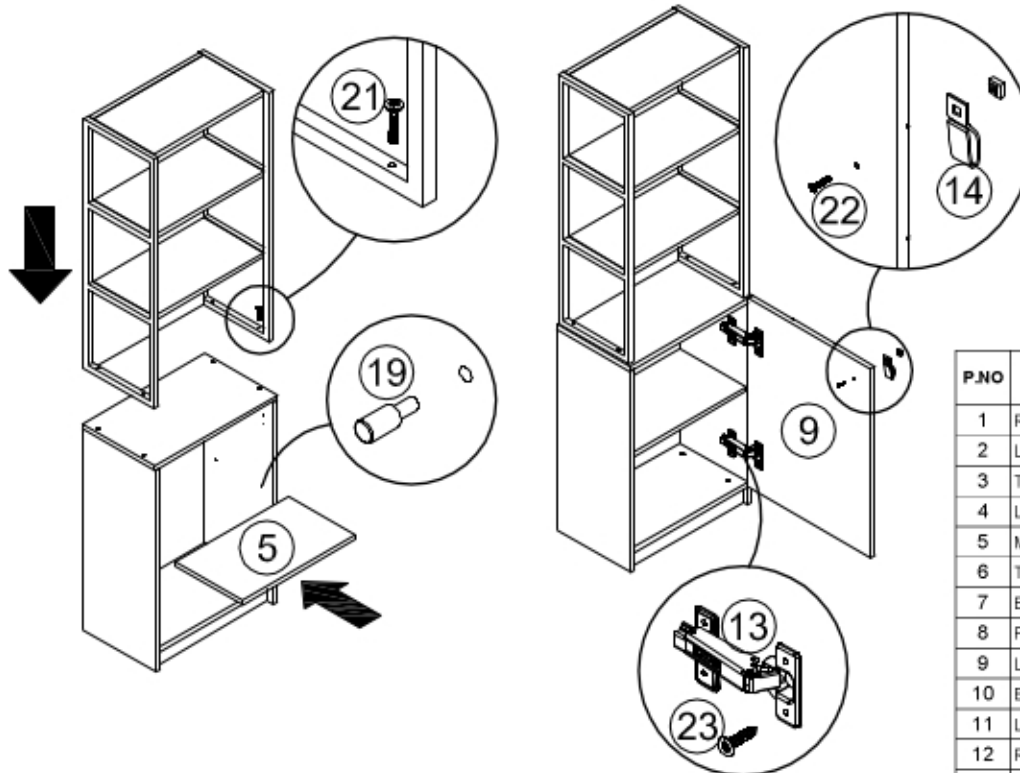

P.NO	TRACK NAME	COLOUR	QTY	THICKNESS	MEASUREMENT	
					X	Y
1	RIGHT SIDE	ATLANTIC PINE	1	18	732	305
2	LEFT SIDE	ATLANTIC PINE	1	18	732	305
3	TOP TABLE	ATLANTIC PINE	1	18	514	305
4	LOWER TABLE	ATLANTIC PINE	1	18	474	540
5	MOBILE SHELF	ATLANTIC PINE	1	18	474	280
6	TILL	ATLANTIC PINE	1	18	474	64
7	BACK PANEL	ATLANTIC PINE	1	18	905	462
8	PANEL SHELF	ATLANTIC PINE	3	18	462	255
9	LID	ATLANTIC PINE	1	18	686	514
10	BACKREST	ONE FACE WHITE	1	5	660	484
11	LEFT IRON	BLACK METAL	1	20	905	295
12	RIGHT IRON	BLACK METAL	1	20	905	295
	ASSEMBLY MATERIAL BAG					